



# GOOD GRIPS®

22 lb Food Scale





Thank you for choosing the OXO Good Grips 22 lb Food Scale! OXO's user-friendly Food Scale with Pull-Out Display is perfect for weighing all ingredients, eliminating the need for multiple measuring cups and spoons. Weigh items directly on the platform, on a plate, or in a bowl, and pull the display away from the base for better visibility. Measure ingredients while cooking and baking, stick to a diet by weighing portions, or weigh fruits, vegetables and more. Easily switch between measuring weight and volume without the need for a new bowl. The Scale can measure the volume of water-based ingredients and comes with a conversion chart to measure the volume of other ingredients like oil or flour. Before you get started, please familiarize yourself with the many features of this useful Scale.

## TABLE OF CONTENTS

---

Product Features	pg 3
Features	pg 4
Getting Started	pg 6
Switching Between Weight & Volume	pg 7
Caring for your Food Scale	pg 7
Satisfaction Guarantee	pg 7

## PRODUCT FEATURES

---

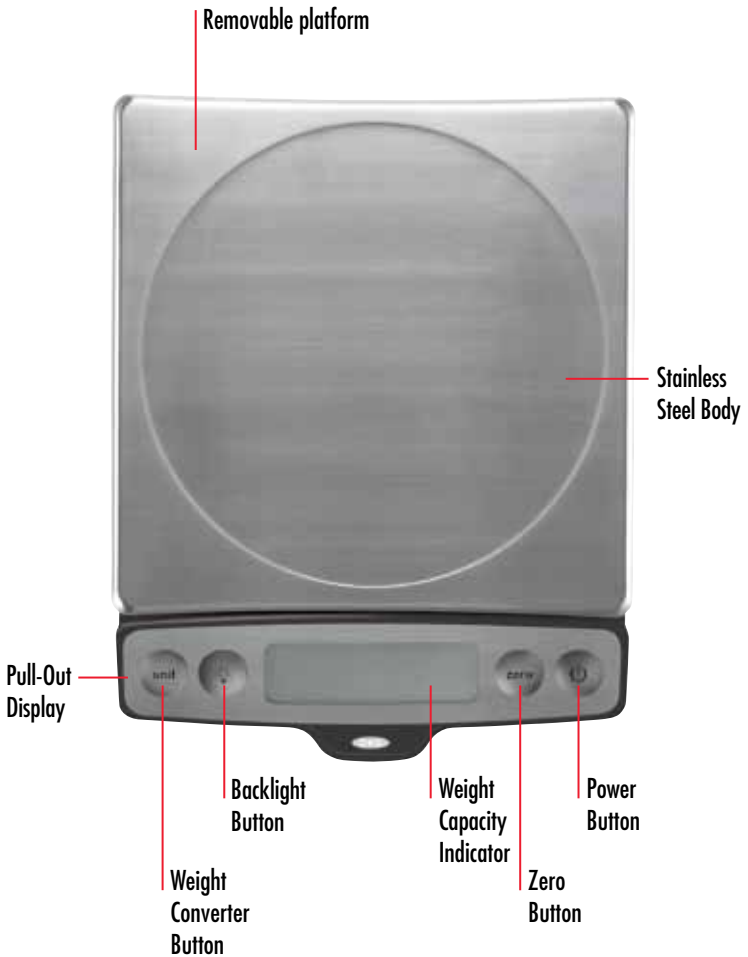

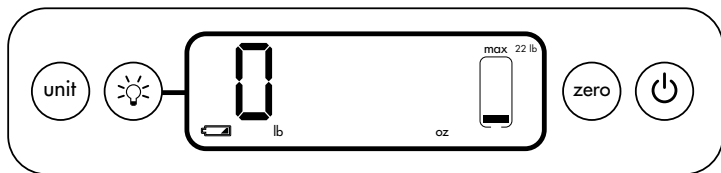

### Pull-Out Display

The display unit can be pulled away from the Scale for better visibility if it is obstructed by a large bowl or plate. To retract, simply replace the display unit and magnets will secure it in place.

### Backlight Button

Press the backlight button to light the display unit for better visibility. To preserve battery life, the backlight will automatically turn off after 30 seconds.

### Zero Button

Press the zero button to reset the Scale before adding additional ingredients or to offset the weight of a plate or bowl.

### Weight Converter Button

Press the weight converter button to switch between measuring weight and volume.

### Conversion Chart (included)

Refer to the conversion chart to measure the volume of non-water based ingredients like oil, flour, eggs and more.

## Weight Capacity Indicator

The weight capacity indicator shows the used capacity of the Scale between 0 and 22 lbs (or 0 and 10 kg). When maximum capacity is reached, all bars in the indicator will flash and “Err” will appear on the display. To protect Scale, remove excess weight immediately.

## Removable Platform

The stainless steel platform can be lifted and removed to hand wash for thorough cleaning. To reattach, simply line up the tabs on the bottom of the platform with the holes in the base unit and push platform back into place.



## Low Battery Indicator



The low battery indicator will appear in the lower-left corner when batteries need to be changed.

## Standby Mode

After 6 minutes of inactivity, the display will switch to standby mode and the memory will be retained. Touch any button after 6 minutes to return the Scale to active mode.

## Shut Off

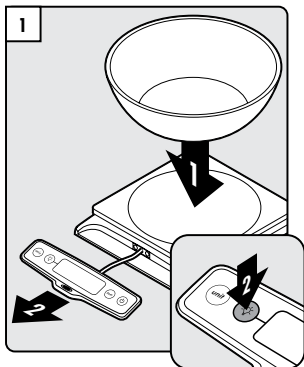

After 30 minutes of inactivity, the Scale will shut off and memory will be lost. To turn the Scale on again, press the power button . To turn Scale off manually, press and hold the power button  until display is blank.

1. Press the power button , wait for the scale to count down 3-2-1. Display will read 0 when ready.
2. Press the weight converter button  until scale reads desired unit of measurement.

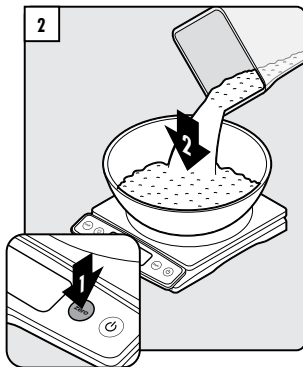

1. Place bowl on scale.
2. Pull out display and/or turn on backlight  for better visibility.



1. Press zero button .
  2. Slowly begin adding ingredients until scale reads desired amount
- To add second ingredient, press the zero button  again and begin weighing until the scale reaches desired weight.

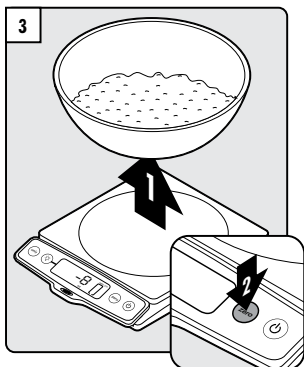

1. After the bowl is removed from the Scale, a negative number will appear on the display.
2. To reset Scale back to zero, press the zero button  and begin again.

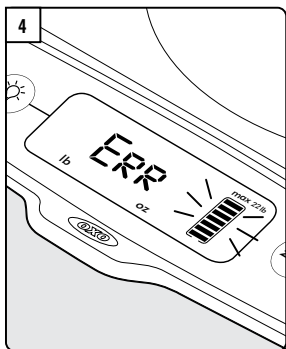



When maximum capacity is reached, all bars in the indicator will flash and "Err" will appear on the display. To protect the Scale, remove excess weight immediately.

## SWITCHING BETWEEN WEIGHT & VOLUME

---

### Weight Converter Button

- Measuring by weight: To switch between US (lb and oz) and metric (kg and g) units at any time during weighing, press the weight converter button .
- Measuring by volume (water-based ingredients): To measure the volume of water-based ingredients, press the weight converter button  until it reads “cup” or “mL”.
- Measuring by volume (non water-based ingredients): To measure the volume of ingredients of different densities, refer to the included conversion chart

## CARING FOR YOUR FOOD SCALE

---

**Battery Loading** (Four AAA Batteries Included): Locate battery compartment on the bottom of the Scale. Push tab in to remove battery door. Ensure +/- ends of batteries line up with +/- symbols in battery compartment. Replace battery door.

**Cleaning:** Gently lift and pull stainless steel platform off the base unit to remove for cleaning. To reattach platform, line up the tabs on the bottom of the platform with the holes in the base unit and push the platform back into place. Do not put the platform or base unit in the dishwasher.

**Storage:** Do not place heavy objects on top of the Scale during storage. Doing so may affect the accuracy of the Scale.

## SATISFACTION GUARANTEE

---

We guarantee everything we make!

If for any reason you are not satisfied with the 22 lb Food Scale, you may return it for replacement or refund. Please contact OXO's customer service department at [info@oxo.com](mailto:info@oxo.com) or (800)545-4411 and we will be happy to assist you.

**SATISFACTION GUARANTEED**

If for any reason you are not satisfied with this product return it for repair, replacement, or refund.

[www.oxo.com](http://www.oxo.com)